

# FOR LEASE Folsom Faire

## SEC E. Bidwell Street & Glenn Drive Folsom, CA

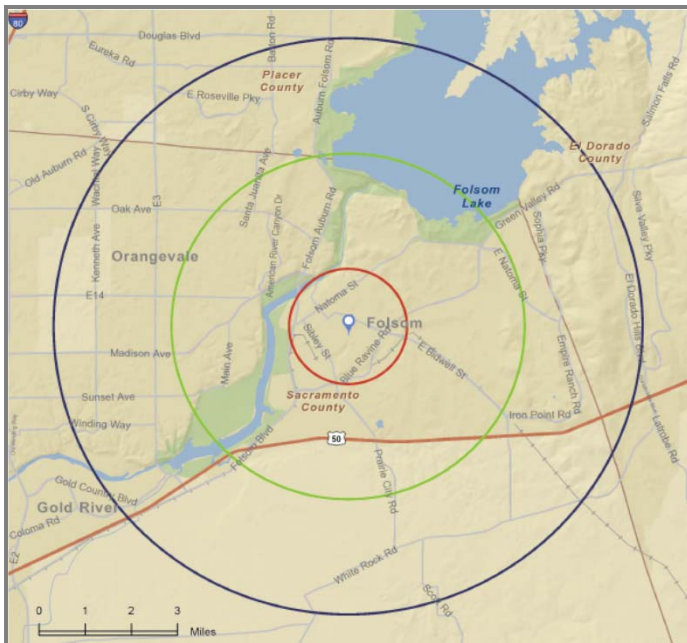

INTER-CAL REAL ESTATE CORPORATION



# FOR LEASE Folsom Faire

SEC E. Bidwell Street  
& Glenn Drive  
Folsom, CA

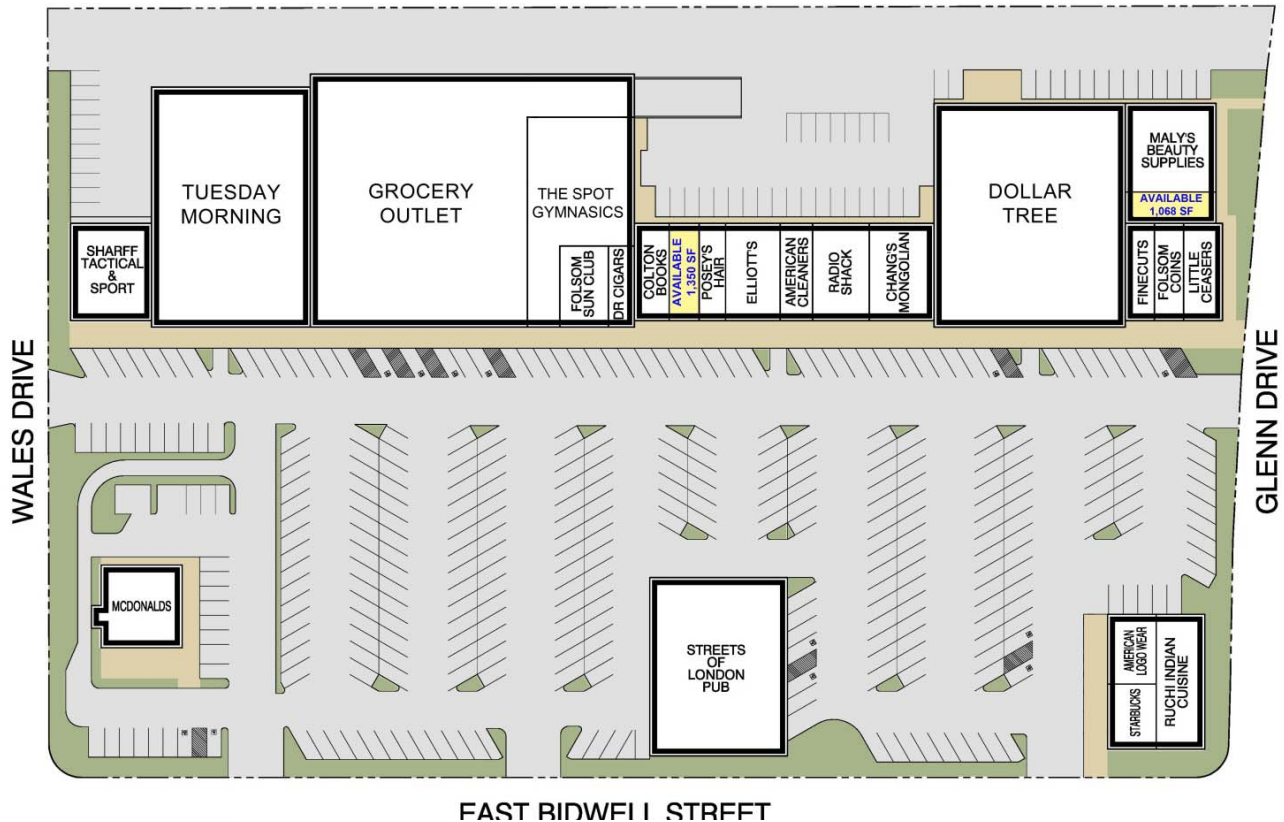

## PROPERTY HIGHLIGHTS:

- Centrally located near Wal-Mart, Kohl's, Target, Lowe's & other national chain tenants.
- Well-established shopping center located on East Bidwell Street, the trade area's primary traffic corridor.
- Excellent visibility, easy access and convenient parking.
- Please inquire about leasing opportunities at Inter-Cal's adjacent property, Folsom Central.

## DEMOGRAPHICS (2010 Est.):

	<u>1 Mile</u>	<u>3 Mile</u>	<u>5 Mile</u>
Population:	11,612	80,165	144,123
AHH Income:	\$82,188	\$98,243	\$106,475
Average Daily Traffic:	13,353 (Glenn Drive & Riley Street)		

Source: U.S Bureau of the Census. Esri Forecasts for 2010. DataMetrix.

INTER-CAL REAL ESTATE CORPORATION



**FOR MORE  
INFORMATION  
CONTACT:**

Deron Conway

Director of Leasing

(916) 489-4600

Deron@intercalre.com

icalre.com